

Specifications



Industrial Grade Mowers & Offset Arms

The Mowing Industry's best Bang for your Buck!

DESCRIPTION

XH1500 Series 3

XH1000 Series 3

Cutting width	180" (4.57m)	126" (3.20m)
Overall width	190" (4.83m)	139" (3.53m)
Overall length	192" (4.88m)	192" (4.88m)
Transport width, min	88" (2.24m)	88" (2.24m)
Transport height	88" (2.24m)	88" (2.24m)
Deck thickness	7GA (3/16") (4.6mm)	7GA (3/16") (4.6mm)
Weight range, approx.	5550lbs (2500kg) - 6100 lbs (2750kg)	5100 lbs (2300kg)
Transport hitch weight, approx.	1900lbs (864kg)	1800lbs (800kg)
Minimum tractor HP	65 HP (52kW)	50 HP (45kW)
Recommended tractor HP	85 HP (67kW)	75 HP (60kW)
Cutting height	1.5 to 17.5" (38 to 144mm)	1.5 to 17.5" (38 to 144mm)
Ground clearance, transport	17" (444mm) (24" tires)	17" (444mm) (24" tires)
Cutting capacity	4" material (102mm)	4" material (102mm)
Blade overlap	6.5" (165mm)	6.5" (165mm)
Divider gearbox rating	260 HP (194kW)	260 HP (194kW)
Centre/wing gearbox rating	190 HP (142kW)	190 HP (142kW)
Blade tip speed,	540 rpm	540 rpm
Centre	848 rpm, 15,981 ft/min (4871m/min)	848 rpm, 15,981 ft/min (4871m/min)
Wing	986 rpm, 15,493 ft/min (4722m/min)	986 rpm, 15,493 ft/min (4722m/min)
Blade tip speed,	1000 rpm	1000 rpm
Centre	850 rpm, 16,022 ft/min (4883m/min)	850 rpm, 16,022 ft/min (4883m/min)
Wing	1002 rpm, 15,743 ft/min (4798m/min)	1002 rpm, 15,743 ft/min (4798m/min)
Wing working range	25° down to 90° up	25° down to 90° up

FLX15/FLX10 FLEX ARM

Heavy duty, 31 x 13 x 12, 20 ply aircraft tires
 Offset distance for the FLX15 is 36" to 122"
 Offset distance for the FLX10 is 12" to 88"
 Large 2-1/2" diameter castor pivot spindles
 6000 lb capacity, 6 bolt hubs
 Spring steel bushings at all major pivot points
 Hoses provided for routing of 3 hydraulic circuits
 3 X 24 3000 psi, hydraulic cylinder on FLX15
 3 X 20 3000 psi, hydraulic cylinder on FLX10
 Weight of FLX15 arm is 1850 lbs
 Weight of FLX10 arm is 1650 lbs
 Safety light kit
 Bolt in replacement axles



- XH1000 Series 3 unit shown above -



Schulte Industries Ltd.,
 P.O. Box 70, Englefeld, Saskatchewan, Canada S0K 1N0
 Tel: (306) 287-3715 Fax: (306) 287-3355
 E-Mail: info@schulte.ca
 Visit our Web site at: www.schulte.ca

ISO 9001:2000



Sold By:

PRINTED IN CANADA PREPARED by NELSON GRAPHIC DESIGN 200608



G O N U M B E R O N E . . . G O S C H U L T E !

XH1500 Series 3

The Schulte XH1500/XH1000 Series 3 Rotary Cutters are the latest version of Schulte's popular heavy duty rotary cutter line. They retain all of the best features of the original XH1500/XH1000 Rotary Cutters, such as tandem walking axles, heavy duty drive line and deck protection rings, while adding many new improvements. Below is a listing of key features.



Drive Line A four gearbox drive line arrangement with a forward mounted power divider allows the use of individual slip clutches to protect the cutter. The four gearbox drive line allows the wings to operate at angles from 25° down up to transport position.

Domed Deck (New on Series 3) Single domed sweep clean deck eliminates build up of debris and prevents rusting on the top side.

Gearbox Mounts Heavy duty gearbox mounting pads are able to handle the roughest working conditions. Gearbox bolts can be retightened from the top side.

Tandem Walking Axles with tapered roller bearings result in smooth operation over rough surfaces.

Floating Hitch (Industry First) The hitch lifting rods use a sliding sleeve that allows the cutter's front skids to pass over an obstruction without tending to lever up the back of the cutter or bend the hitch lifting rods.

Aircraft Tires With larger 24" aircraft tires, transport height is increased to 17.5" allowing for an easier ability to cross approaches and improved performance in wet conditions

Welding Top side of deck is continuously welded to increase structural strength and minimize rusting.

TESTIMONIALS



KEN SINGELTON - Custom Cutter (Kennedy, SK)

"I love the clean top single domed deck. It stays clean and sheds water perfectly. The heavy duty gearboxes have worked flawlessly. No problems at all and they run very cool. The new low maintenance drive lines are great. Less time servicing and more time making money cutting. The 17.5" lift height means I don't scalp when going over approaches and reduces blade wear from ground to blade contact. I have recently put on some Equal Angle Hitches on 3 of my Schulte XH1500 cutters and they are working beautifully. No heavy CV shaft to hook up. The increased depth of the body of the cutter allows material to feed in the front better and flow through better. I have increased my ground speed by over 1 mile per hour over my previous model. Chain guards will be easy to maintain with the slide through rod design. A great improvement! The centralized rear suspension makes for a stable and smooth ride when transporting from location to location. I really like the Schulte Super Suction blades in combination with this cutter. They really suck up the tractor tracks, even in heavy wet grass. I run tractors in the 105 - 115 HP range and the Schulte cutters have worked great with my tractors."

LAWRENCE KNITTIG - RM #368 St. Peters (Annehlem, SK)

"With the wet conditions in 2005 and 2006 most of our ditches couldn't have been cut without the Schulte Flex Arm. I have seen reduced tire maintenance on our tractor with the use of the Flex Arm. Our operator fatigue has been greatly reduced with the use of the Schulte Flex Arm. A Lot of our roads could not be cut without the Flex Arm because of wet and steep slopes. The Schulte Flex Arm is worth its weight in gold."

ROB HULGAN - RM #290 (Kindersley, SK)

"I can travel at least 1 mile an hour faster than I could travel with the series 2 cutter. I like the Easy to clean the deck. I Have used the Flex-arm for 4 years. If I had to go back to cutting without the Flex-arm I would not be operating the cutter."



FLX15/10 FLEX ARM

The new standard in offset mowing technology from the innovators of the best rotary cutters in the world! The Flex Arm Increases operator safety, comfort and performance, in fact operators who have had a chance to use the Schulte FLEX-ARM say comfort & safety are the best features!

Increase operator safety, comfort and performance with the revolutionary Schulte Flex-Arm. The Schulte Flex-Arm allows the operator to travel on the road while his Schulte 10' or 15' rotary cutter cuts the ditch slope. The tractor does not have to ride on the ditch slope so rollovers are very low risk. As an added bonus, wear and tear on the tractor is greatly reduced. Visibility is improved. The operator is placed in a better position to view obstacles before they reach the rotary cutter. The FLEX-ARM and Schulte cutter can be used in wet conditions, which could make cutting more difficult if the tractor had to ride on the slope. Because of the unique way in which the FLEX-ARM is attached to the rotary cutter, it can be easily backed up to cut around approaches and other obstacles.



Schulte 15' and 10' Flex wing rotary cutters incorporate a strut mount which allows the Flex Arm to become an integral component of the cutter and allows the two units to work as one. This greatly eliminates side draft from the cutter to the tractor and allows the two units to be backed up easily as if they were one unit.

KEN STOCKBURGER - RM #339 Leroy (Leroy, SK)

"Keeping the tractor out of the ditch reduces cuts and flats on the tractor tire and less tractor maintenance with the tractor running level. We can cut much closer to sloughs in wet years, no more getting stuck, no ruts in ditches to bounce over the next year.

We haven't rolled a tractor since we have started using the Schulte Flex Arm. When cutting brush the tractor is in the open and away from the trees. The operator can see what he is doing much better. We also use the Flex Arm when we are doing our back cut. We never unhook. Our new series 3 XH1500 is working very good. We can cut around 5 miles a hour.



Walking Axle (Industry 1st) The walking axle is supported by two tapered roller bearings placed on both sides of the walking beam with a 1 3/8" lock head shaft running through. This walking axle suspension is positioned as far forward as possible to best control cutter height over uneven ground. Available with optional wing walking axles for better floatation cutting.

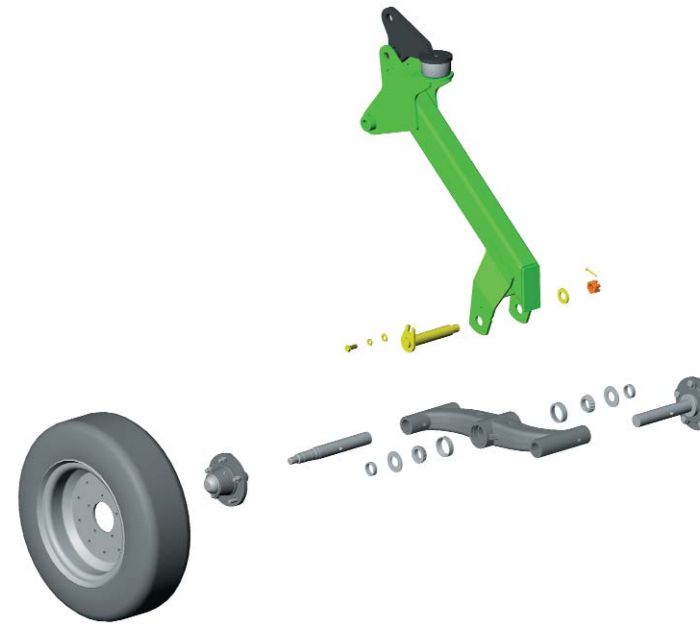

Wing Lift Wing lifting lug runs through the deck and is then capped on the underside to totally eliminate any chance of coming loose even if the wing is suspended off the ground during operation.



Stump Jumpers 1/4" thick spun & pressed formed (dynamically balanced) stump jumpers with patent pending Pentagon Blade Bolt design allows cutter sections to ride over obstructions. Flat 1" thick blade bar design with heavy duty 3/8" cross bracing prevent premature wear and cracking.



Swivel Hitch A swivel hitch allows the cutter to move over rough terrain without the hitch clevis binding up onto the tractor drawbar. The swivel assembly uses a strong 2" main shaft. Should the assembly loosen up over time machine bushings can be added to maintain a snug fit. A spring steel bushing protects the hitch frame from wear.

Shielding Comprehensive drive line shielding allows the use of short bells on power shafts resulting in better access to grease zerks. The shielding can be easily unclipped for access to gearboxes, slip clutches and universal joints. A self-locking latch and support straps apply force under the main shield to prevent it from rattling.

New Hingeline Cast hinge with a wiper seal prevents blow through of grass and material to the top side of the deck, and improves welding area to frame.

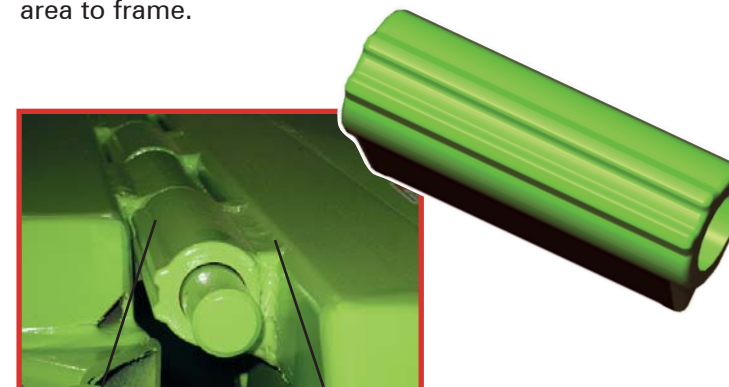

Wiper Seal

Flat surface weld area

Blades/Options Various blade options are available from Schulte. Such as: Schulte Super Suction, Standard suction, brush blades and shredder blades. Whatever your application Schulte has your blade.

Pentagon Blade Bolt Our stump jumpers feature a Pentagon Blade design with C1045 replaceable bushings, welded into the crossbar, ensuring years of trouble free use! a Schulte exclusive!



Hoses Hoses can be organized along the right or left side of the centre frame so that shielding covers can more easily be tilted back for service access.

Leveling (Industry First) Outer wing wheels include an adjustment screw that can be placed out of level up or down 3". This allows the cut height to be fine tuned across the machine for precision cutting along roadsides.





Centre Suspension



Wing Lift lock up with rubber stopper

Rear Beam The centre section wheel standard uses a large 6" O.D. x 5.5" I.D tube. The lifting system is symmetrical resulting in an even loading on both sides of the centre frame. Spring steel bushings and high carbon steel pins are used at all pivot points.

Wing Suspension with rubber grommet. Lock head pins with greaseable replaceable spring steel bushings at all major pivot points ensures proper lift height for the life of your Schulte cutter.

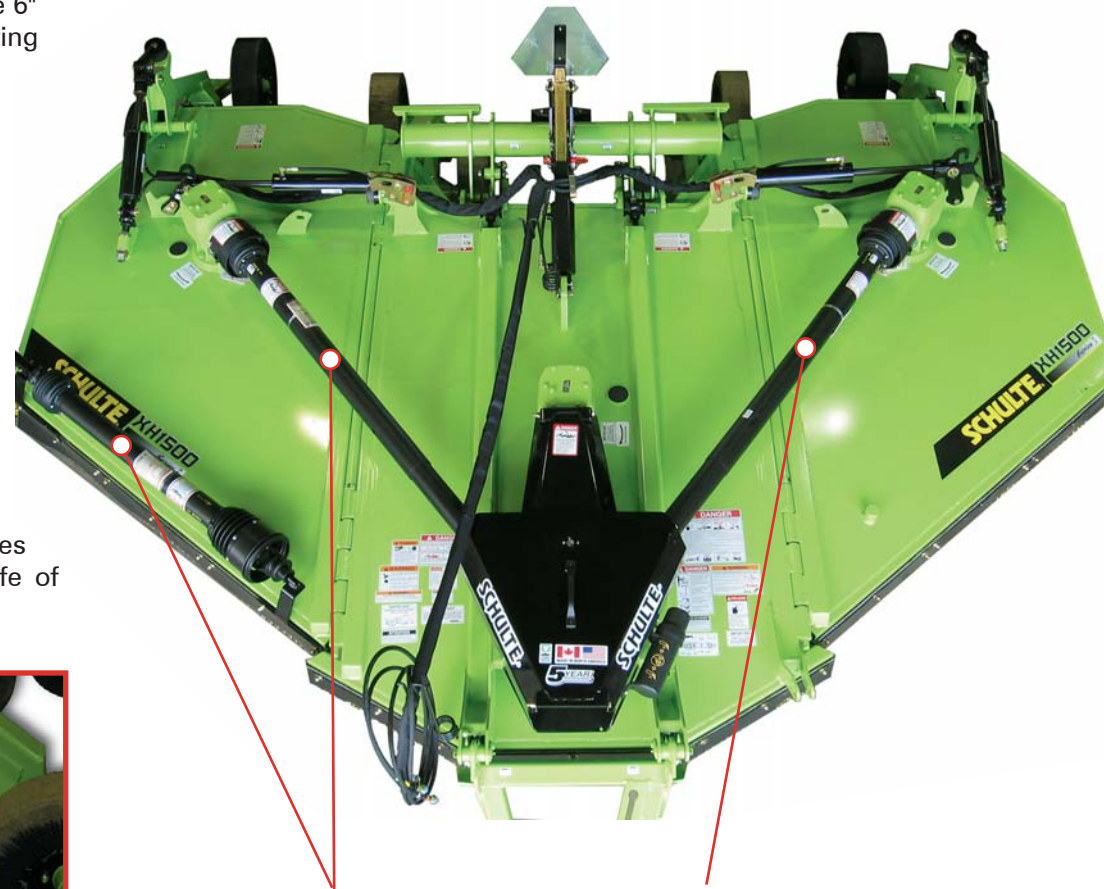

Drive System A Bondioli & Pavesi SFT drive system is used with 50 hour lube service on universal joints or the optional Schulte exclusive Equal Angle Hitch, Non-CV Drive



260hp Splitter Box with forward mounted self adjusting clutches for easy servicing



190hp Right Angle Gearboxes Heavy Duty 1 3/4" Input Shafts. 2 3/8" Tapered and Splined Down Shafts. Five year limited gearbox warranty.

Centre Skids Replaceable High Tensile Skid shoes are a two piece design. The shoes can be removed entirely when cutting over level ground.

Wing Skids Replaceable High Tensile Outer wing skids are two piece. The forward section is extra wide to prevent gouging and can be mounted outside or inside the side skirt depending on requirements.



Double Safety Chains With individually replaceable links are standard equipment **Front Rubber Belting** prevents blow of material and thrown objects

Power Shafts Power shafts are low maintenance (only need greasing every 50 hrs) and have shorter bells for better access to grease zerks. All power shafts have tapered pin type connections instead of split clamp.



Metal Axles seal guards protection over hubs, with bolt in replaceable axle

Increased Frame Depth A frame depth of 12" and high blade tip speed results in a better cut and a superior flow of material.



Deck Rings. (Industry First) 3/8" thick formed deck rings are welded to the under side of the decks. These rings prevent the blades from contacting the deck should a blade become bent. Deck rings have been standard on the Schulte XH models since 1992.



Center Lock up System with adjustable depth stop which allows for narrower transport width



Narrow Transport The NTM (Narrow Transport Mechanism) is incorporated into the center hydraulic lock up system. The wing wheels can be tucked inside of the width of the wings when in transport mode allowing for a stable, safe and ultra narrow transport width of 88".

Phased Hydraulic cylinders are standard to provide level lifting across the width of the cutter. Centre and wing sections all raise and lower together. Cutting height is controlled by the centre depth stop for one touch levelling.